

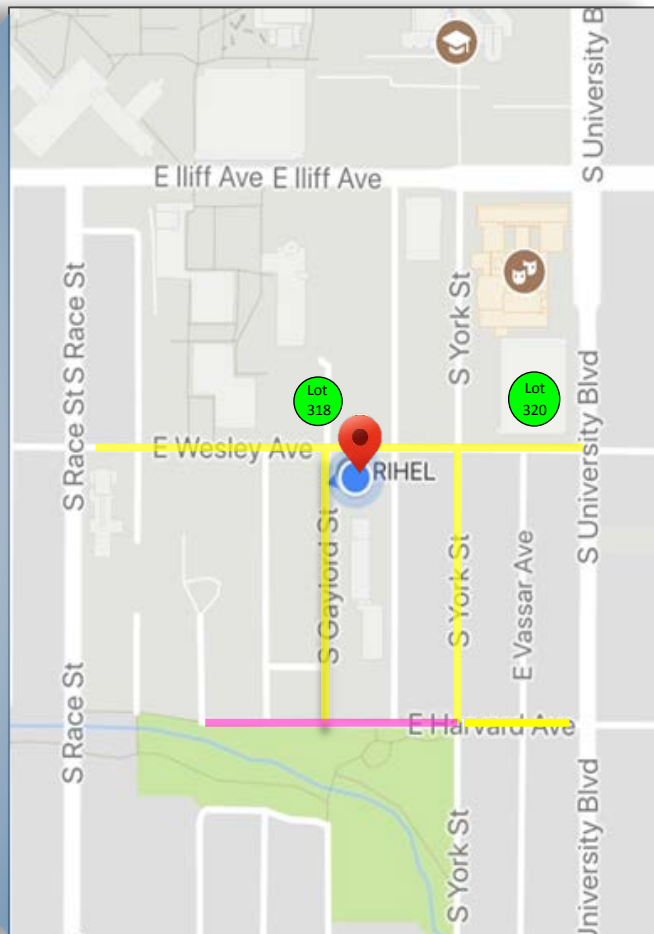

# RIHEL Office Location and Parking

2400 S. Gaylord St.  
Denver, CO 80208-5100



The RIHEL office is located in the “Academic Offices Annex” on the corner of S. Gaylord St. and E. Wesley Ave. Please use the entrance on the north/Wesley Street side of the building. There are steps and a ramp that both lead to our door. This door is always locked, so please ring the doorbell and a staff member will let you into the building.

## PARKING

- **Free Street Parking:** The streets marked in yellow on the map have no time limit. The street marked in pink next to the park (Harvard St.) has a 2-hour time limit.
- **Pay Lots:** There are two University of Denver visitor pay lots very close to our building (marked with green circles on the map). You must pre-pay (credit or debit card only) at the terminal on each lot, and the rate is \$1.50 per hour.
  - **Lot #318** – open-air parking lot, across the street from our building.
  - **Lot #320** – first floor of parking structure, on the corner of E. Wesley Ave and S. University Blvd.
- Please **DO NOT** park in the small lot directly behind our building. This is permitted parking only, and is not available for RIHEL guests.